

# Land and Ocean On the move

Taiwan - History, Geopolitics, Art & Culture  
towards Kuroshio Current  
research project

Artist in Residence at  
BAMBOO CURTAIN STUDIO  
Exchange program 2017  
Between  
Baan Noorg Collaborative Arts and Culture  
& Bamboo Curtain Studio

## INTRO

This research project is part of Baan Noorg Collaborative Arts and Culture's research project commenced in 2017. I am responsible for Taiwan part, the first country of destination of this project.

Last year, Baan Noorg ran AIR project and an exchange program with Bamboo Curtain Studio (BCS). It has created along term collaboration. The BCS has become the host of the research in Taiwan. This was my first time of research journey in abroad and Taiwan.

This report is considered a primary note taken during the field studies at selected locations. Further research and development is still in process.

- Saphitchaya Khunchamni -



# CONTENT

## Residency Main Missions

- **Experience gained** ①  
*from participating in  
2017 Art Management  
Brainstorming  
Workshop by BCS*
- **Taiwan - History,  
Geopolitics, Art &  
Culture towards  
Kuroshio Current  
research project** ③  
*3 surveying study  
locations:*
  - = Taitung County
  - = Orchid Island
  - = Toucheng  
township, Yilan  
County
- ④  
**Research results:**
  - = Influence of the  
Kuroshio Current on  
Taiwan's geography and  
inhabitants' living
  - = The influence of  
Kuroshio Current on  
Taiwan culture
  - = Influence of the  
Kuroshio Current on  
Geopolitics
- **Artists interview** ④
  - Lee Jo Mei, *Ishigaki Jima*, 2009
  - Wu Chi Yu, *Refraction*, 2015

**Experience gained  
from participating in  
2017 Art Manager Brainstorming  
Workshop by BCS**

**Technical term of management**

Presentation topic: Corporate Social Responsibility (CSR)  
by Nongrat Thanjitt (Nay)

*If we consider about art project with CSR, we should view it as a corporate group mission to drive the project together for creating the awareness of responsibility on society or environment.*

*They also engage with education, environment and charity work that involve with exhibition, education program, training venue, learning center, eco art project, art and design media to make campaign for charity etc.*

*Furthermore, we should not forget sponsors, partnerships that we share benefit with similar purpose.*



## Art action awareness workshop by Bamboo Curtain Studio

### Action practicing/ thinking

Can you be a leader?

- Brainstorm workshop  
Leadership - brainstorming what is the leadership?
- Action learning workshop - for development.  
Thinking to fix problem, question practicing & focus on sharing and finding the way to fix problem/discussion

### Example: Art action for awareness (to make an impact)

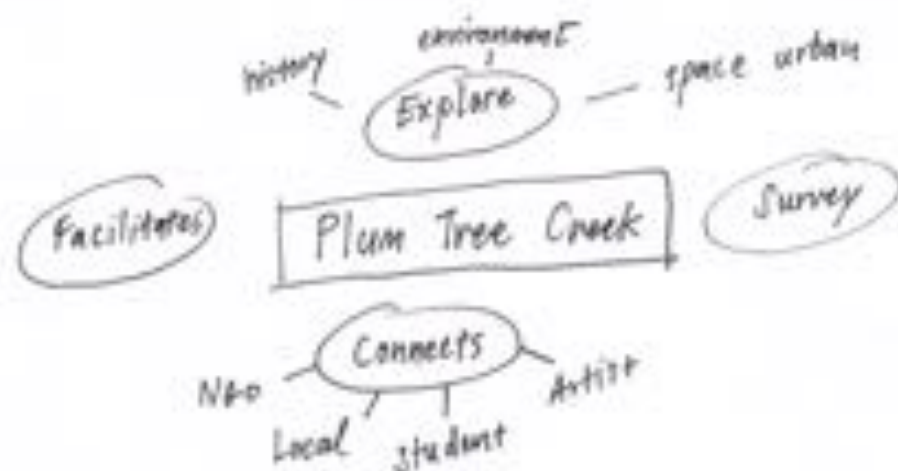

It is interesting to see how the Bamboo Curtain Studio using the space with multifunction arrangement in one space and how they run project with strategies.

For Artist in residency, Artist Studio (Sun Son Theatre), Ceramic, Cafe for making income.

Doing the sustainable project, not pop-up

Activities/the project make impact

Social, History & Art Combine together.

Artistic practice program / alternative interdisciplinary

## Taiwan - History, Geopolitics, Art & Culture towards Kuroshio Current research project

**A research project of BNCAC**

In cooperation with Bamboo Curtain Studio

*This surveying journey in the North and the Southeast Coast of Taiwan is the beginning part of the SEA - History, Geopolitics, Art & Culture towards Kuroshio Current project.*

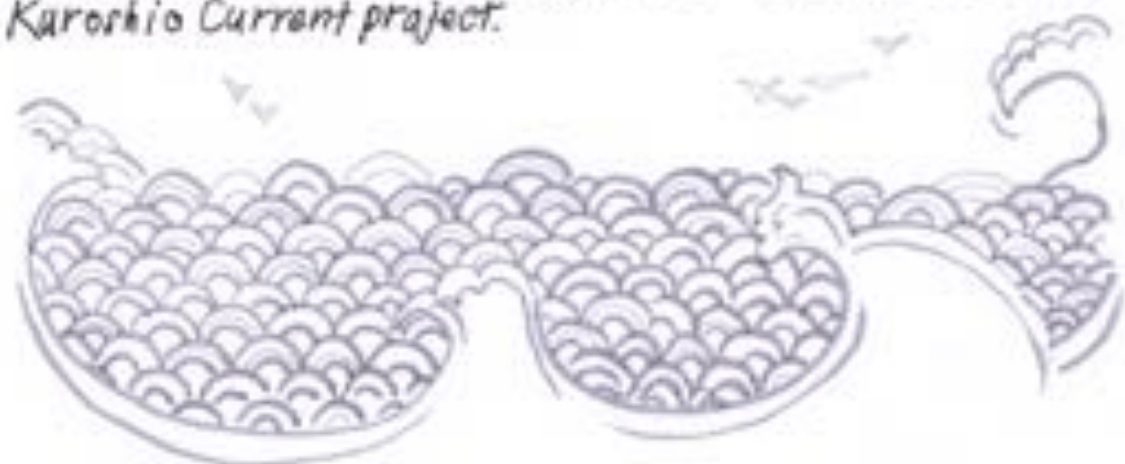

### **3 SURVEYING STUDY LOCATIONS**

*Study locations include 3 site specific sites Taitung, Orchid Island and Toucheng Township, Yilan.*

*Its fundamental process are surveying the sites and interviewing local inhabitants, cultural leaders, researchers and artists.*

*At each locations, The research focus on local history, geopolitical, cultural information through oral history, architecture and art works from selected artists whose works associate with the area of study or artists who have information and development that reflect or relate to the influence of Kuroshio Current.*

## RESEARCH RESULTS

from 3 locations

The research result can be divided into 3 main aspects

1.

### Influence of the Kuroshio Current on GEOGRAPHY & INHABITANT'S LIVING

People on Taiwan Island, live with the ocean, face to the nature that always change and often confront with the outsiders that enter the island from past to present.

In terms of the rich natural resources in the forest and the sea, the Black Current brings fishes, crabs etc. from the deep ocean into these area and most people in present time still fishing.

At the **Orchid Island,**

Flying fishes are still main resource for their living. And from an interview with Yin Zhen, the owner of hostel where I stayed, she said that woman cannot participate fishing flying fish activity.



Shaman Lamutan said, every year there is flying fish ceremony (Tatara) Boat launching ceremony and Millet festival on Orchid Island.

Quinoa  
In  
Taitung!



Millet - Millet Wine making, there is in the indigenous culture.

At Orchid Island



While in Toucheng Township, Yilan County, fishing ports are very important for the inhabitants there.

Wu-shi port was inaugurated in 1826



At Luodong Township, Yilan County the Cypress trees are economic resource of the area that drew attention to Japanese in the old days.



Map of Cypress in Taiwan  
in A Featured Exhibition on  
the Legendary Cypress of Yilan,  
Lanyang Museum.



## 2. The influence of Kuroshio Current on TAIWAN CULTURE

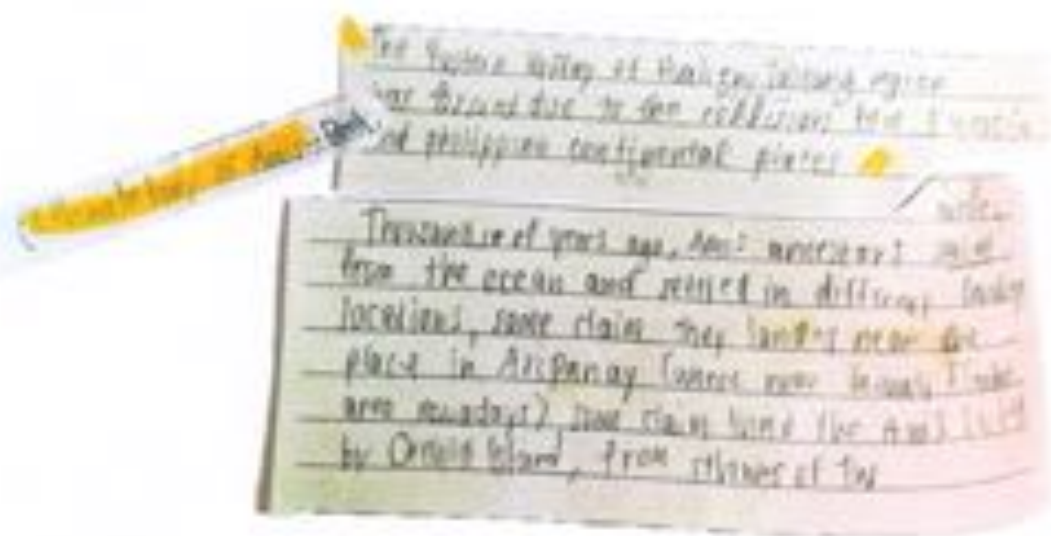

Through some historical evidence and the oral history that was collected during the research process, there has been similar cultures in the region such as languages, ways of living, ceremonies, architectures, etc. that derived from immigration between archipelago Philippines and Taiwan in the early time around thousand years ago.

Besides this, there were some claims about immigration such as Ethnobotany of Amis's book explained that the Amis ancestors sailed from the ocean and settled in the land of Taiwan in thousand of years ago.

## Language

In Taitung, in a ceremony part of TECLand Art Festival, Ma Sag, an Amis elder, used Amis language during the ceremony.

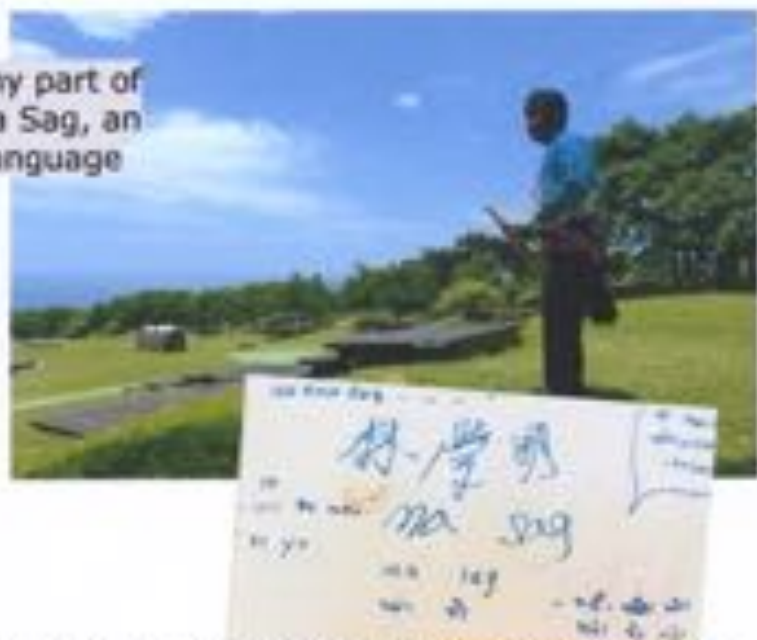

Agung Dewi, an Indonesian art manager from Bali Island could understand the meaning of some words like Lima (means five), Mata (means eye), and many other words can be found in regional indigenous language text books that I will continue to explore.

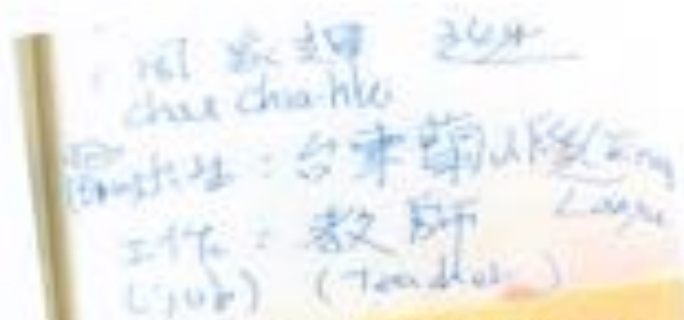

In Orchid Island, from an interviewing with Chou Chia Hui, teacher at Yayo Elementary School and Shaman Lamuran, president of Tao foundation, they explained that Tao peoples can understanding on Batanes language (the archipelago of Philippines) is about 50-60 %.

## Architecture

New settlements had created diverse culture that can be found from historical places or some left symbols that present the cultural exchange between Taiwan and outsiders such as the architecture, churches and graveyards in Taitung. At every villages are similar to those in Orchid Island with 2 kinds of Christian churches.



In Orchid Island, Shaman Lamuran's interview has shown that Canadian, Portugal missionaries came around 1960 and translated the bible into Tao language. In the church, there is a wall painting of Tao style. In Orchid Island there is only one Buddhist temple.



There is Land god, buddhist temple in Taitung, and Toucheng Township, there are many sea gods that related to people's way of living near the sea or river.

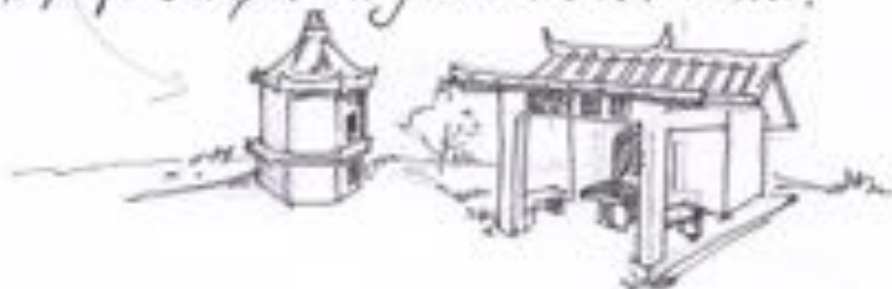

### 3. Influence of the Kuroshio Current on GEOPOLITICS

In Toucheng, Yilan County

*Kan Chi Wu, local people there explained about her grandparent experience in the Japanese occupation that even though the Japanese government has made them unfairly treated, but under the strict law, their social order is safe and orderly, and even her grandparents did not need to lock the door at night, they could feel at ease to sleep. In the Second World War, Taiwan got attacked by the US military aircraft missiles. They were fallen into the panic of the bomb attack and that was memorable the most fear and at that time they did not have enough food, clothing and normal life (grandmother told Kan Chi).*

**Some buildings that show the traces  
of outsiders came to the area**

*Weather station in Orchid Island*

*was built in the Japanese rule period, mentioned by Shaman Lamuran that it was attacked by American during WWII.*



### **The Elementary Schools**

are buildings that were built in the Japanese rule period, Shaman Lamuran explained that Japanese opened schools in Hongtou (Imored) Village and Dongqing (Irameylek) Village. They let children go to study in the schools but not everyone of them were able to go to school.



A map from Japanese in a Culture and Art of the Botel Tabago Island book when I was in Taitung. There are names of Village of Orchid Island.



Elementary school in Hongtou (Imored) Village.

Toucheng has Japanese buildings that were built in the Japanese occupied period. It has become principal's dormitory of Toucheng elementary school. It was restored later, in 2005.



## Dulan Sugar Factory was built in Japanese rule period.

03.06.2017

In Taitung, there were 2 sugar factories built during Japanese occupation period for getting resources from Taiwan. When Chinese National Government came, the factories were still working but finally they did not continue because economic changed and now artists use it for art space and cafe.



### Collected traces of outsiders,

We can see the racial political situation derived from the oceanic migration, there are changes that influenced the island. New settlements were made on the island from Han dynasty to Qing dynasty of China until the Japanese rule period of 1895-1945 and also the present time.

## The influence on local language

From mother language to the occupier language and central or official language, among my interviewees, there are elders over 80 years old who can speak Japanese such as Ma Sag, Amis people in Taitung as well as Shaman Lamuran's grandmother is also able to speak Japanese.



When the Kuo Min Tang (KMT) government ruled Taiwan, Mandarin language became central or official language. The mother language and Japanese language only used in some groups.

## The influence on traditional house

Tao people's life had changed by the civilization, the government used to let them build their houses in modern style and also natural materials were replaced with durable materials.

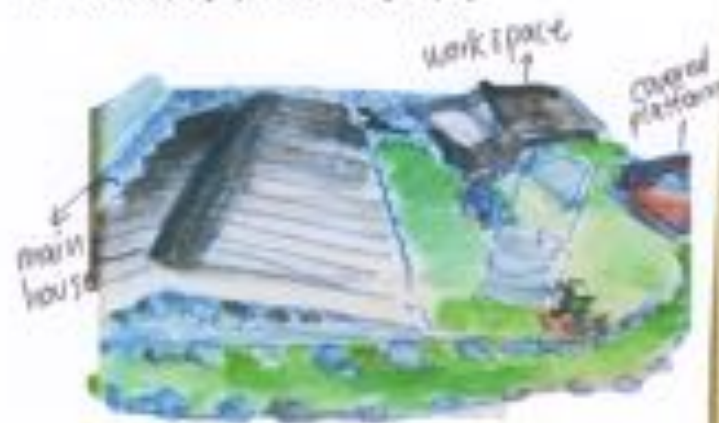

at Sualline Village!  
Orchid Island



At Taitung, through interviewing Wu Shu Lun who studied indigenous art. She explained why there are more modern buildings now because in Chiang Kai Shek (C.K.S) time, they convinced people to destroy their own decoration and traditional style. They suggested that it will bring more civilization to [it]. While the traditional tattoo style also used different way. Since Dutch people stayed here for a period, about 60 years. Shu Lun described we can see some of indigenous traditional clothes and belts that look similar to the Dutch army uniforms.

Turtle Island  
le



In Toucheng Township, there has been the attempt to occupy the sea territory. Through an interview, there is a period where Taiwan government ordered inhabitants on Guishan Island to move to mainland in order to be the site for military of government to face with Japan.



Lee Jo Mai  
Taipei Artist



Xu Hong Da,  
live in Toucheng Township



## Artists Interview

Wu Chi Yu and Lee Jo Mei, the interviewing selected artists who have created works that are related to the subject of territories, geopolitics and changes that influenced human mind or livings.

*Apart from bringing rich resources, the warm current also brought foreign affairs. Concerning to the geographical site of Taiwan, there were many confrontations with China and Japan. Through surveying and interviewing, It appeared Taiwan's strong relationship with these two countries.*

*According to Lee Jo Mei, her artwork in 2009, the title is Ishigaki Jima and the story was about immigration of her ancestors who want to live on Ishigaki Island.*

*There were news on the website: Japan Times, described that president Lee Teng-hui said Ishigaki and Taiwan developed a close relationship during the Japanese colonial period, from 1895 to 1945. In 1930s, Taiwanese farmers emigrated to Ishigaki, bringing with them water buffalos and skills for growing pineapples. Later, when the World War II ended, the relationship between Taiwan and Ishigaki continued.*

*Ishigaki Jima, 2009  
HD single channel video,  
color, 20min, 12" x 10"  
Installation*



Noted from interviewing with Wu Chi Yu, behind his work "Refraction 2015" to some of his artworks include "91 square meter of Time" exhibition,

There were stories of the movement of Taiwan from the past until nowadays such as time, history and relationship between China and Taiwan which related to the ocean.

From his artworks, they were collected from stories that involved multidimensional of time and space. It included his research and experience such as during the historic time through the story of the origin of Tao people on Orchid Island that it was related to the Dutch Christian's preaching and also related to the map on the book by Dutch navigators in the early time.

There was some part of his artworks that connected to geography and politics between Taiwan and China, it involves sea territory through the image of the huge reefs, ship sailing, biological and the image of missiles in 1996 situation.

Refraction, 2015



# THANK YOU

Residency exchange program between  
Bamboo Curtain Studio  
Baan Noeng Collaborative Arts and Culture

Talk Venue  
Open Contemporary Art Center

Research field studies

Taitung County  
Taitung Dawn Artist Village  
Wu Shu Lun and family  
Chou Chien Pang

Orehid Island  
Chou Chia Hui  
Huang Yin Zhen  
Shaman Lamuran

Toucheng Township, Yilan County  
Xu Hong Da  
Chang Chun Shan  
Feng Jen Hong  
Lu Ai Ling

Research interview Artists  
Lee Jo Mei  
Wu Chi Yu





Bamboo  
Curtain  
Studio



Baan Noorg  
Collaborative  
Arts and Culture

**Artistic report**

**Research and documentary** Suphitchaya Khunchamni

**Illustration** Suphitchaya Khunchamni

**Residency duration** 2017 May 17<sup>th</sup> - June 26<sup>th</sup>

**Editor** Baan Noorg Collaborative Arts and Culture

© August 2017, Baan Noorg Collaborative Arts and Culture

All rights reserved. Copyrights of the texts are reserved for the author; of the interview dialog for interviewees; of the illustrations for the illustrator; of the photographs for the photographers.